

Picnic Time Emergency Escape Route for Building 2

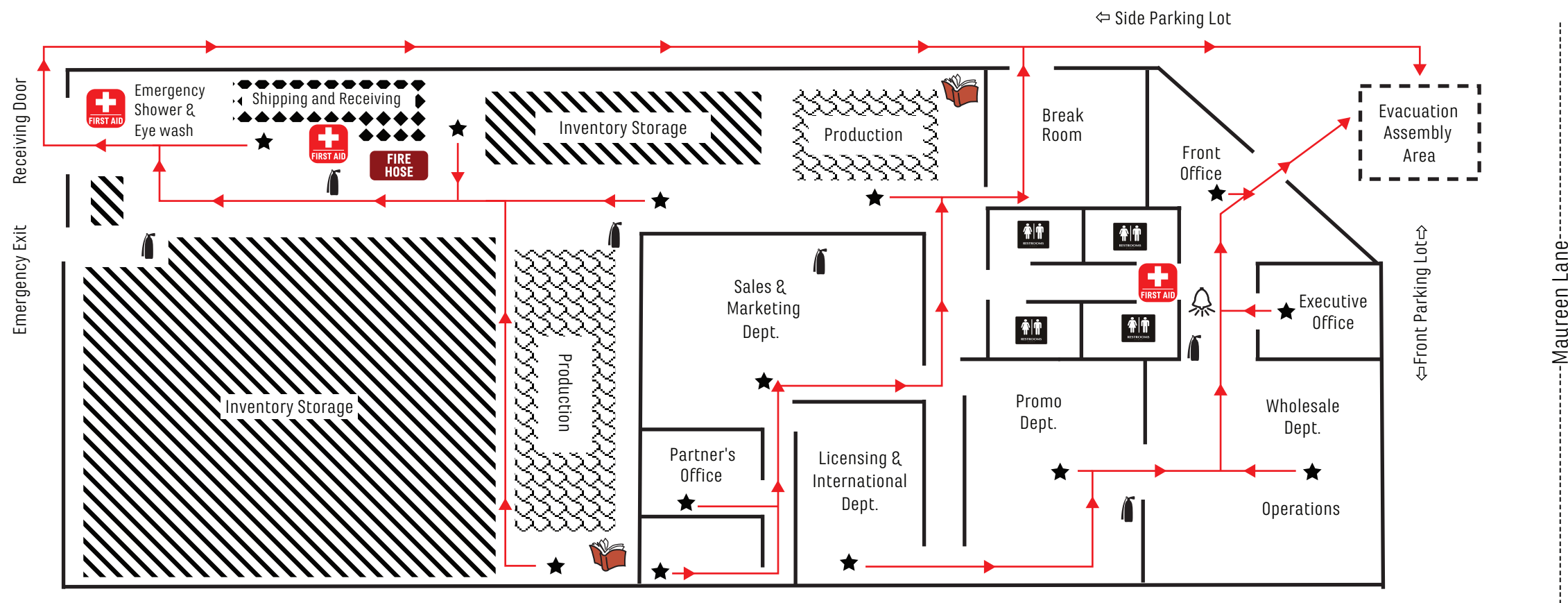

First Aid



Fire Extinguisher



Fire Hose



Material Safety Data Sheets



Alarm - Sounds alarm in the building;
Press corresponding button as shown: (F)ire, (A)mbulance, (P)olice

A floor plan shows the possible evacuation routes in the building. Building 2 has three main exits: two in the upper left of the diagram and one in the upper right of the diagram. People in the left half of the building should head towards the back of the building and exit through the emergency exit or the receiving door. People on the right half of the building should head towards the main entrance/exit at the front of the building through which employees enter and exit the building. All exits are open during business hours (M-F, 8:30 am to 5:00 pm). People in the warehouse that are closer to the main entrance/exit should proceed through the door that separates the warehouse from the office. People on the 2nd floor should walk down the stairs to the main level.

A person's current position is marked by "★ You are here" which is followed by a series of colored arrows to each exit. Colored arrows represent the various evacuation routes. All escape routes end at the Evacuation Assembly Area which is located in the parking lot, directly in front of the building. Here, attendance will be taken.